

DNB306 - ANEMOMETRO SONICO / Sonic anemometer

DNB306.1 - ANEMOMETRO SONICO RISCALDATO / Heat sonic anemometer

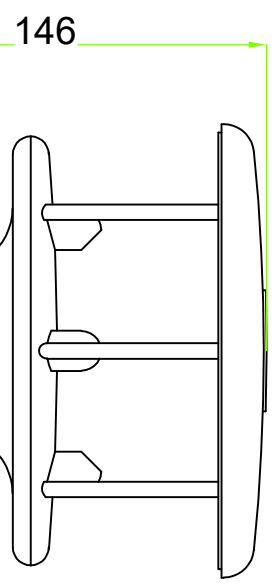

CAVVO / Cable:
DWA831 DWA832 DWA833

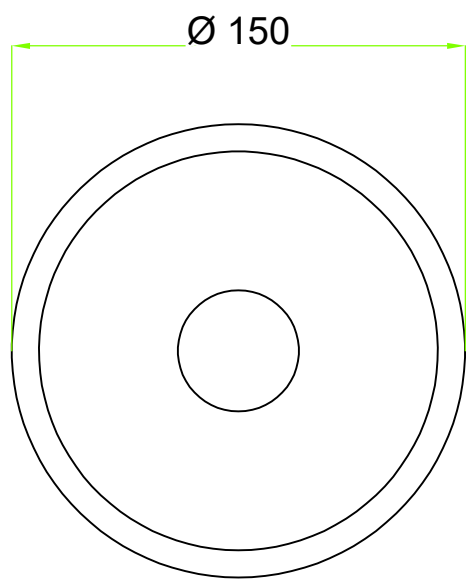
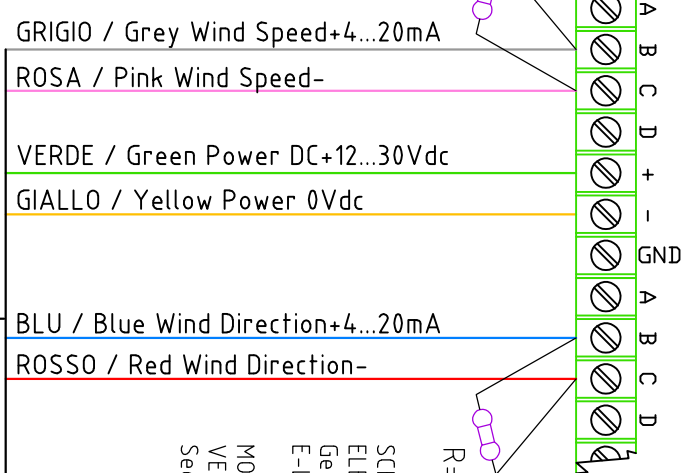

VIOLA / Purple Heating Power +24Vdc@10A
NERO / Black Heating Power 0Vdc

ALIMENTATORE / Power supply 24Vdc

SCHEMA GENERICO DI CONNESSIONE ELETTRICA A DATA LOGGER E-Log/ALEM / Generic electrical connection to E-Log/ALEM data logger

MORSETTIERA / Terminal board VEDI MANUALE UTENTE DATA LOGGER / See data logger user's manual

SOLO PER SENSORE SONICO RISCALDATO / Only for heated sonic anemometer DNB306.1

Indice di revisione	Data	Modifica effettuata	Indice di revisione	Data	Modifica effettuata
a	---	---	d	---	---
b	---	---	e	---	---
c	---	---	f	---	---

DATA	REDAITTO:	CONTROLLATO:	VERIFICATO:	APPROVATO:
A4	UT	R&S	RA	RT

OGNUNO DIMENSIONI	Tolleranze mm.	Prefab:
1 - 18	±0.1	---
>18 - 80	±0.15	---
>80 - 250	±0.25	---
>250	±0.35	---

Tutte le informazioni ed il manuale utente possono essere scaricate dal sito WWW.LSI-LASTEM.COM / All information and the user manual can be downloaded from website WWW.LSI-LASTEM.COM

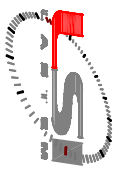

Descrizione:
Sensor/Sonic/Vel+Dir-vento/2x4-20mA/10-30V / Sensor/Sonic/WS+WD/2x4-20 mA/10-30V

n° dis.: DISACC220052

Rev.: -

Cod. prodotto: DNB306

Materiale: ---

FATTORE DI SCALA: 1.25